

Important: Read all instructions prior to installation.

Selectable CCT LED Flood Light

Safety and Notes

- Product should be installed and serviced in accordance with applicable national, state, and local building and electrical codes.
- To reduce the risk of electric shock, ensure that the main power source and circuit breakers are switched off before performing any installation or wiring procedures.
- Avoid looking directly into lamp when illuminated.
- Ensure all mounts are securely attached and will support the weight of the fixture. Failure to properly support fixture may result in damage or injury, for which the manufacturer does not assume responsibility.



FLCCT-SW3530-SH8BRU

Specifications

Model FLCCT	SW3515-SH8BRU	SW3530-SH8BRU	SW3550-SH8BRU	SW3570-SH8BRU	SW3590-SH8BRU
Operating Temperature	-4°–122° F (-20°–50° C)			-40°–122° F (-40°–50° C)	
Environmental Rating				IP65	
Dimming	none			1–10 V	

Check product label for specific electrical specifications related to installation.
Improper installation will void warranty.

Color Temperature Selection

Loosen screw on CCT selection switch cover to access switch. With the light powered on, press switch to cycle through CCT options. Re-tighten switch cover screw.

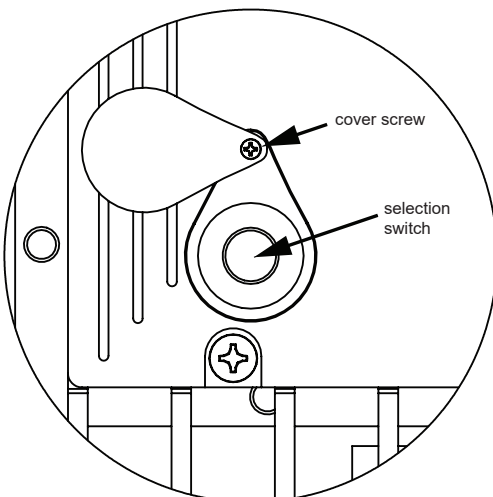

Wiring Diagram

120–277 VAC Input

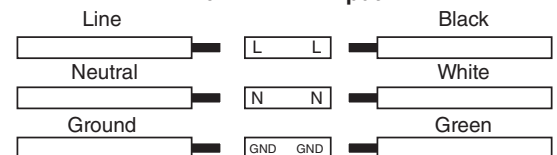

1–10 V Dimming

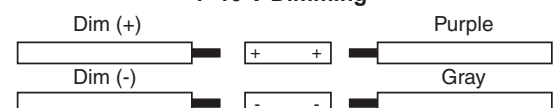

Important: Read all instructions prior to installation.

Selectable CCT LED Flood Light

Installation Instructions (Included U-bracket/Yoke Mount)

1. Drill holes for mounting and wiring.
2. Loosen light head adjustment screws with hex key.
3. Securely attach light to wall and connect wiring.
4. Select desired CCT setting.
5. Rotate light to desired angle and tighten adjustment screws.

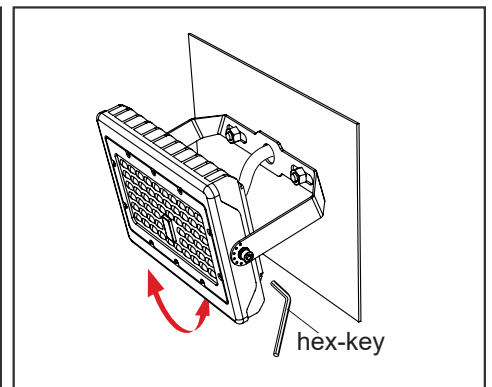
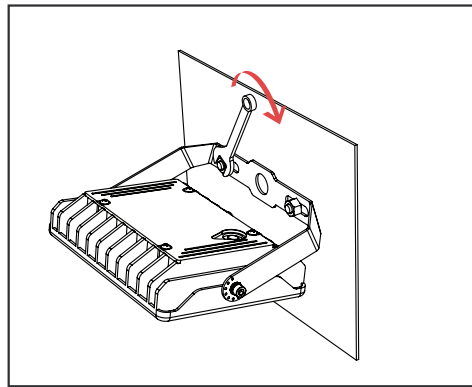
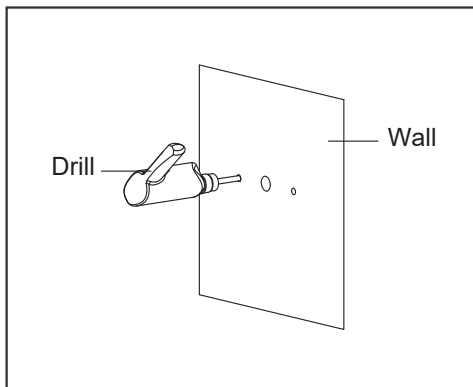

Installation Instructions (Optional Trunnion Mount)

1. Drill holes for mounting and wiring.
2. Attach trunnion mount to light using provided hardware.
3. Securely attach mount to wall and connect wiring.
4. Select desired CCT setting.
5. Rotate light to desired angle and tighten adjustment screws.

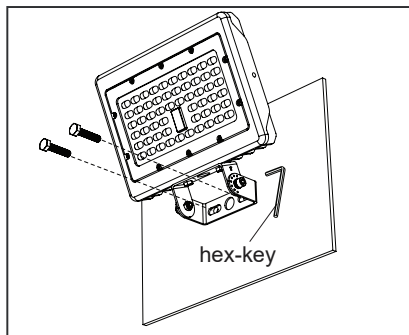
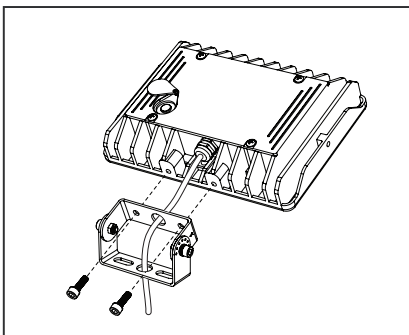

Important: Read all instructions prior to installation.

Selectable CCT LED Flood Light

Installation Instructions (Knuckle Mount)

1. Run wiring through knuckle mount as shown in diagram.
2. Assemble mount.
3. Open junction box and run wiring into box.
4. Securely mount light to junction box. Use sealant to create weatherproof seal.
5. Connect wiring.
6. Replace junction box cover.
7. Apply power and select desired CCT setting.
8. Rotate light head to desired angle and tighten adjustment screw.

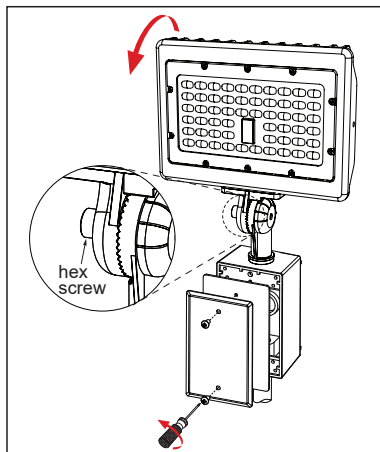
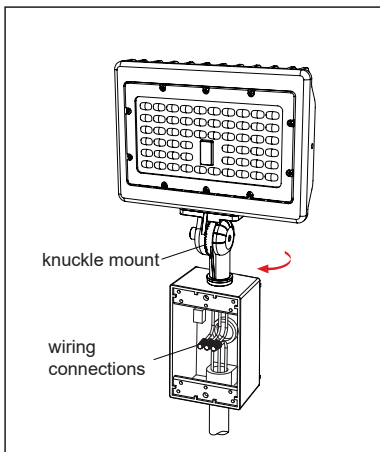
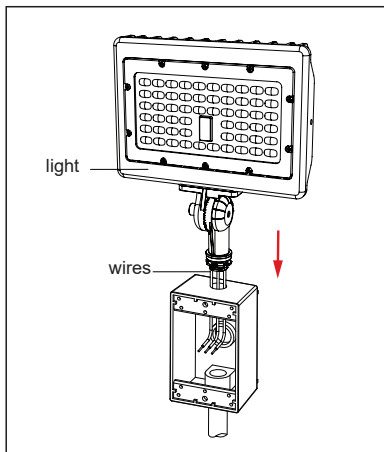
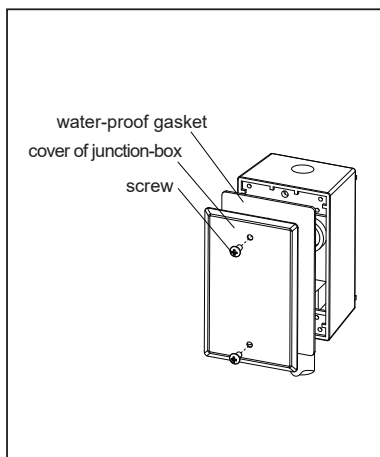
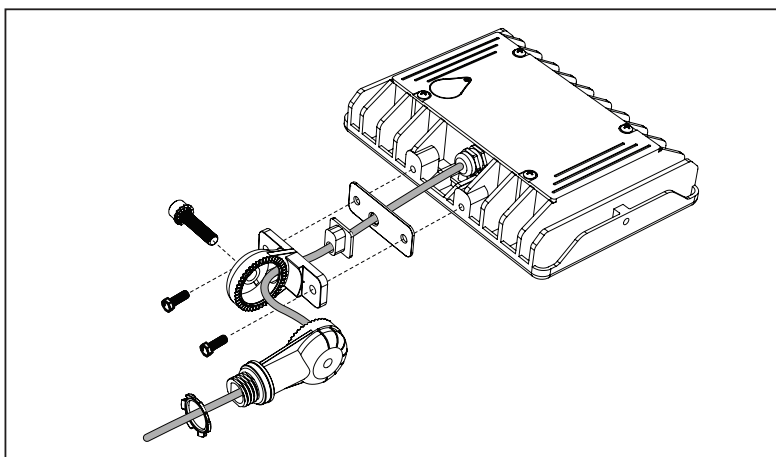

Important: Read all instructions prior to installation.

Selectable CCT LED Flood Light

Installation Instructions (Optional Pole/Slip-fitter Mount)

Only available on 70 W and 90 W lights.

Pole/Post Installation

1. Disassemble mount and run wiring through it.
2. Reassemble mount.
3. Attach mount to light.
4. Drill mounting holes in pole/post and attach mount.

Note: Installation on square poles will not require round pole adapter plate or gasket. See illustration.

5. With supply power off, use access panel to connect wiring.
6. Rotate light head to desired angle and tighten adjustment screw.

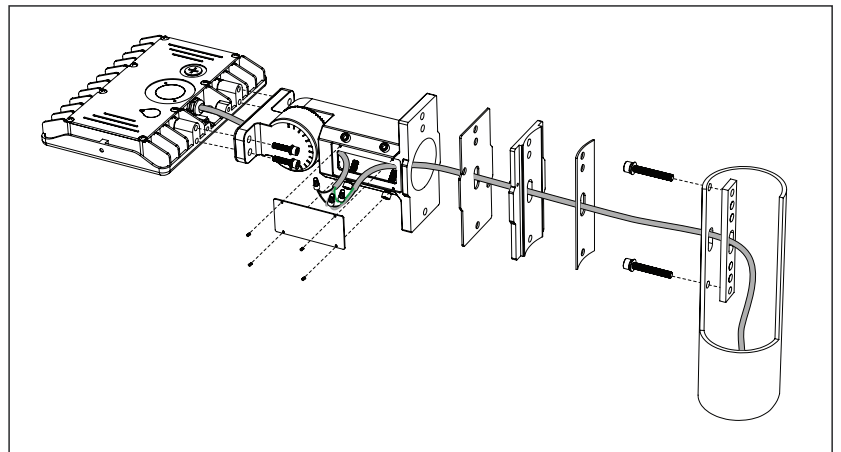
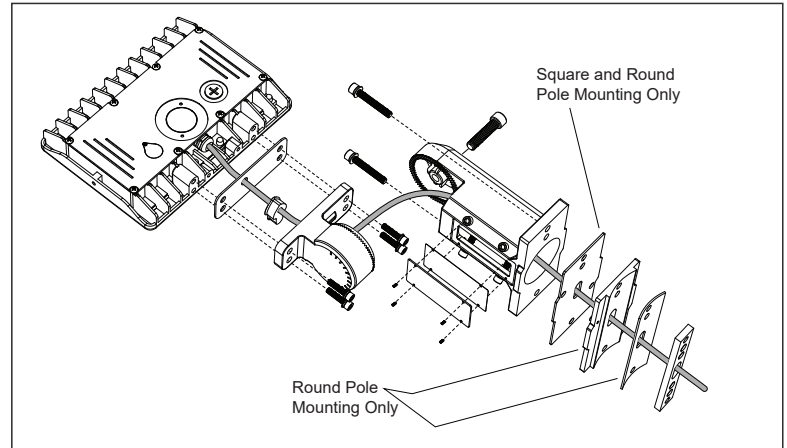

Slip-fitter Installation

1. Disassemble mount and run wiring through it.
 2. Reassemble mount.
- Note: Discard Pole/Post mount components.*
3. Attach mount to light.
 4. With supply power off, connect wiring.
 5. Slide mount over pole/post and secure in place.
The maximum pole/post diameter is 2.375 in.
 6. Rotate light head to desired angle and tighten adjustment screw.

