

Important: Read all instructions prior to installation.

STK-NCCT-5M544-RF-01

Tunable CCT LED Strip Light Kit

STK-NCCT-5M544-RF-01

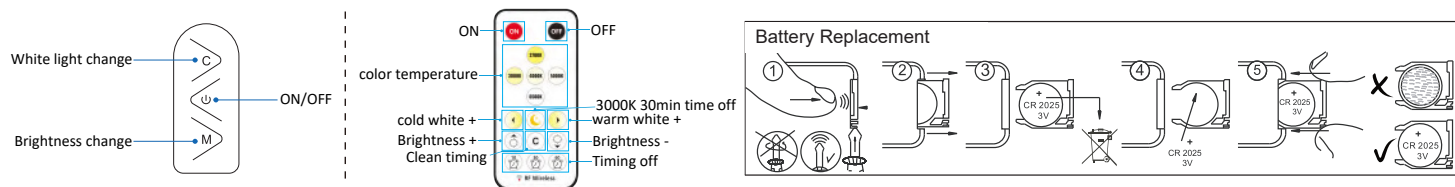
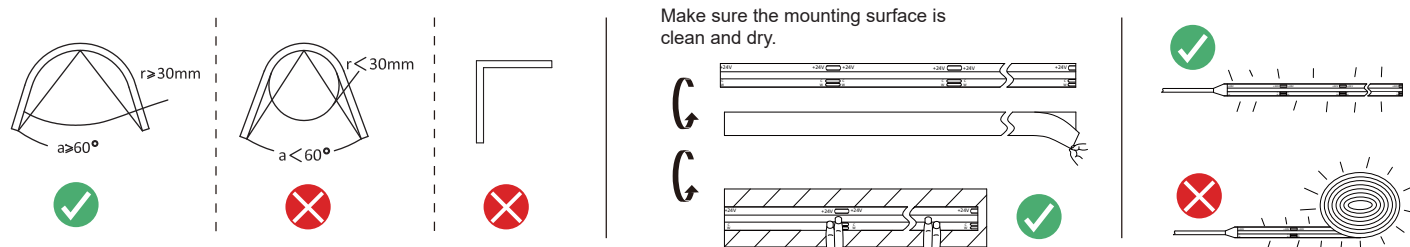
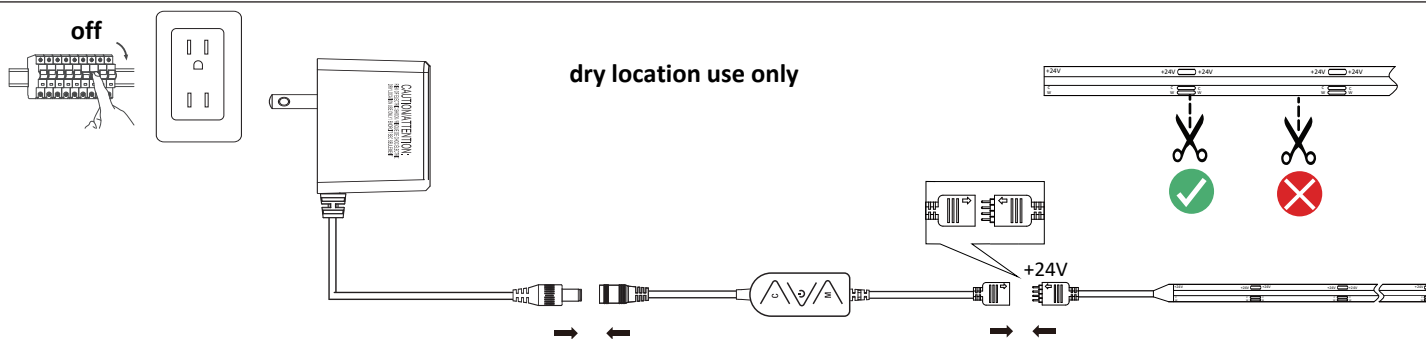
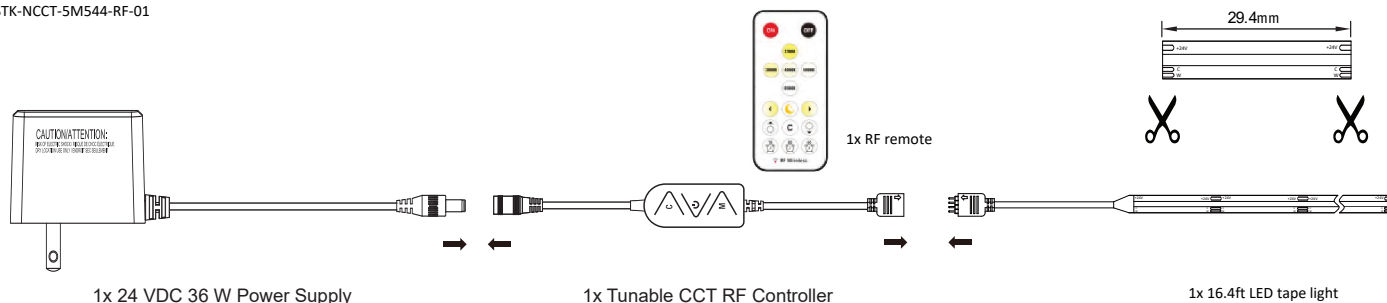

By default, one remote can work with multiple controllers. Follow the process below if you want to assign one remote to a specific controller.

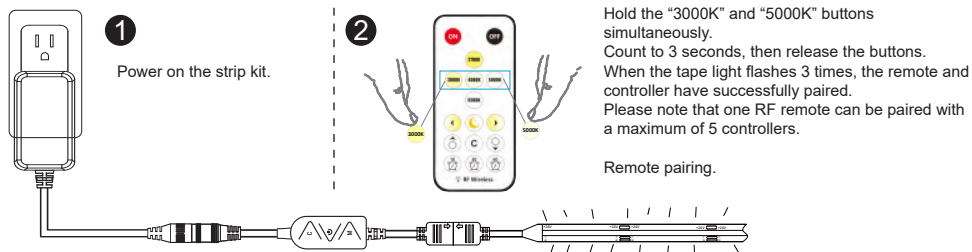

3 When using two or more (up to 5) strip kits, please unplug the power supply for the kits you do not want to pair while matching the remote. Please note, once the remote is paired to a controller they cannot be unpaired.

When using two or more (up to 5) strip kits, please unplug the power supply for the kits you do not want to pair while matching the remote.
Note: Follow the above process to pair the remote with the controller if the tape light turns on or flashes without responding to the remote.

Important: Read all instructions prior to installation.

Tunable CCT LED Strip Light Kit

Battery Warnings

⚠ WARNING	
<ul style="list-style-type: none"> • INGESTION HAZARD: This product contains a button cell or coin battery. • DEATH or serious injury can occur if ingested. • A swallowed button cell or coin battery can cause Internal Chemical Burns in as little as 2 hours. • KEEP new and used batteries OUT OF REACH of CHILDREN • Seek immediate medical attention if a battery is suspected to be swallowed or inserted inside any part of the body. 	

- Remove and immediately recycle or dispose of used batteries according to local regulations and keep away from children. Do NOT dispose of batteries in household trash or incinerate.
- Even used batteries may cause severe injury or death.
- Call a local poison control center for treatment information.
- Non-rechargeable batteries are not to be recharged.
- Do not force discharge, recharge, disassemble, heat above (manufacturer's specified temperature rating) or incinerate. Doing so may result in injury due to venting, leakage or explosion resulting in chemical burns.
- Ensure the batteries are installed correctly according to polarity (+ and -).
- Do not mix old and new batteries, different brands or types of batteries, such as alkaline, carbon-zinc, or rechargeable batteries.
- Remove and immediately recycle or dispose of batteries from equipment not used for an extended period of time according to local regulations.
- Always completely secure the battery compartment. If the battery compartment does not close securely, stop using the product, remove the batteries, and keep them away from children.