

# Magnitude Otter™

Landscape Transformer Series | 150W/300W

## Installation Guide



**FOR USE WITH LANDSCAPE LIGHTING ONLY**



**FOR MODELS**  
**OTR150L | OTR300L**

For use only with low voltage landscape lighting, luminaires, and fittings.

**! WARNING: RISK OF FIRE**

Do not place insulation under terminal plate. Check connection after installation. **If installation involves running wiring through a building structure, consult a qualified electrician.**

**! WARNING: RISK OF ELECTRIC SHOCK**

Install power unit 5 feet (1.524 meters) or more from a pool or spa and 10 feet (3.05 meters) or more from a fountain. Where the power unit is installed within 10 feet (3.05 meters) of a pool or spa, connect power unit to a GFCI protected branch circuit.

**MOUNTING - OUTDOOR USE ONLY**

Mount vertically - with terminal block wiring compartment of enclosure at bottom. Mount at least 1 foot (0.305 meter) above ground level.

Transformer power unit should be mounted close to power source. External extension cords should not be used with this unit.

**PRECAUTIONS BEFORE INSTALLATION**

Read installation instructions before wiring. Check the label and ensure the driver has the proper input voltage and wattage for the job. **INSTALL LIGHTS WITH AC POWER CORD UNPLUGGED AND POWER UNIT TURNED OFF.**

**INPUT CONNECTIONS/GROUNDING**

Connect power unit to a grounded receptacle protected by a GFCI receptable marked "Wet Location" (hooded flush type cover plate).

**OUTPUT CONNECTIONS**

Unplug power cord. Remove the wiring compartment plug caps. Cut and strip appropriately sized load wires and terminate with wire ferrules. Route through wiring

**QUICK SPECS**

Input Voltage	120VAC
Output Voltage	12V, 13V, 14V, 15VAC
Output Wire Gauge	16 AWG to 2 AWG
Enclosure	Outdoor - Wet Location

compartment holes and connect between COM (-) and one of the voltage taps (+). Insert into terminal block at the bottom terminal and tighten to 22.1 lb-in (2.5 N-m) minimum.

Output wire and cable is intended for shallow burial (less than 6 inches (152mm) beneath the surface of the ground). Use appropriate wire and insulation suited for the expected voltage, ampacity, and temperature. Total combined wattage of all lighting bulbs/fixtures on the field installed secondary outputs should be under the wattage rating or capability of this power unit. Call Customer Service if guidance or additional lengths of wire for connection to the secondary is needed.

Run several separate cables to reduce loading per cable, thereby minimizing heat and voltage loss. Any combination of series, split, or tee cables runs would work. The secondary outputs are protected by a trip-free circuit breaker switch that must be ON to operate. If circuit breaker trips, have a qualified electrician check the set-up and operation or call Customer Service for further assistance. For optimum light output, the voltage at the lamp socket should range between 10.8 to 12V.

**IMPORTANT: Keep enclosure door closed during operation.**

**Note: Gasketed conduit connector (shown at right) is recommended to preserve the IP65 rating.**



### INSTALLATION INSTRUCTIONS FOR OPTIONAL ACCESSORIES

#### LIGHT SENSOR SWITCH INSTALLATION

The Photo Switch consists of one (1) sensor, one (1) 3-wire plug with wire nuts, one (1) lock nut and one (1) washer.

1. While facing the front of the Magnitude Otter™, there is a knockout located at the top-right side of the case. Remove this knockout.
2. Feed the three wires from the sensor through the knockout and slide the threaded tube of the sensor through the knockout.
3. Position the rubber washer over the threads and use the self-locking nut to secure the sensor to the side of the unit.



4. Using the three wire nuts, connect the black, white and red wires from the sensor to the corresponding colored wires on the plug.

**Note:** You may need to remove the precut wire covers on the wire to ensure proper connection.

5. Remove the black plug (short link) from the sensor connect outlet.
6. Plug the black connector into the sensor connector outlet on the unit.
7. The light sensor may be rotated to ensure proper operation. Position sensor window away from stray light sources and setting sun.



#### SURGE PROTECTOR INSTALLATION

The surge protector (Part #800-0003) installation location is in the lower right inside of the Magnitude Otter™ case.

1. Before inserting the surge protector, loosen the mounting screw a few turns.

**Note:** The bottom knockout panel can be removed for better access. There are slots with captive screws on each side of the Magnitude Otter™ that secure the bottom panel.

2. Slide the tab, located at the top of the surge protector, into the open tab slot within the Magnitude Otter™ case.
3. Position the surge protector so that the bottom tab slides under the head of the mounting screw.

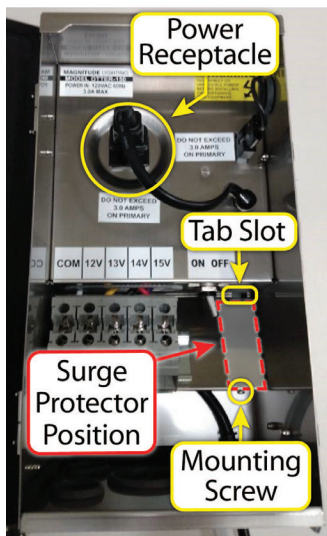

4. Tighten the mounting screw, securing the surge protector.
5. Remove the inner power plug from the power receptacle and plug it into the surge protector.
6. Plug the timer (supplied by other) into the power receptacle.



7. Plug the power cord from the surge protector into the timer, using supplied adapter cord as necessary for better fit.

8. Consult the [Magnitude Otter Timer Fit Guide](#) for more details on using the adapter cord.

9. If you are using the light sensor option or are not using a plug-in timer, plug the power cord from the surge protector into the power receptacle.

