

Important: Read all instructions prior to installation.

WPFC-R1 and WPFCCCT-R1 Series

Full Cutoff LED Wall Pack



WPFC-R1-50K40-LD

Safety and Notes

- Product should be installed and serviced by a certified electrician in accordance with applicable national, state, and local building and electrical codes.
- To reduce the risk of electric shock, ensure that the main power source and circuit breakers are switched off before performing any installation or wiring procedures.
- Avoid looking directly into lamp when illuminated.
- Ensure all mounts are securely attached and will support the weight of the fixture. Failure to properly support fixture may result in damage or injury, for which the manufacturer does not assume responsibility.

Wiring Diagram

120–277 VAC Input

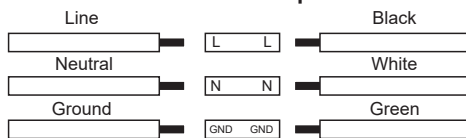

0–10 V Dimming



Specifications

Model	WPFC-R1 and WPFCCCT-R1
Operating Temperature	-22°–113° F (-30°–45° C)
IP Rating	IP65

Check product label for specific electrical specifications related to installation.
Improper installation will void warranty.

Opening Fixture

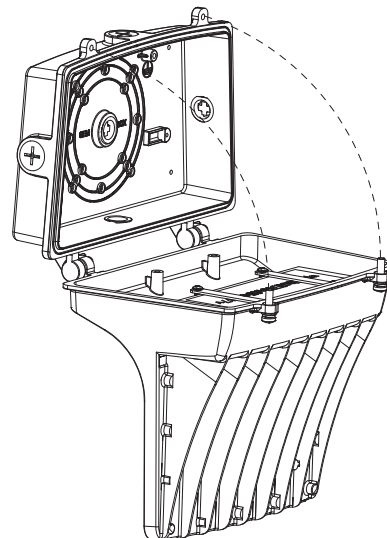
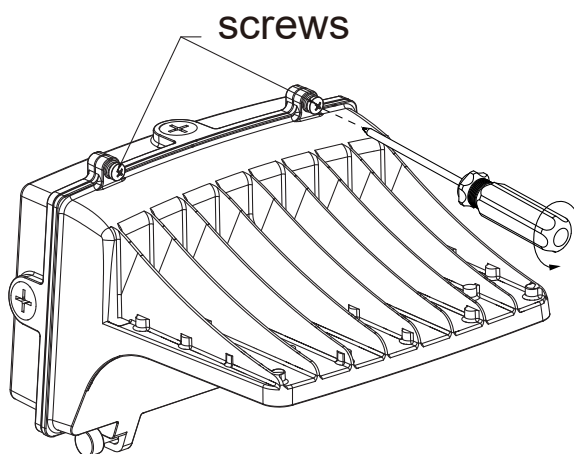

Important: Read all instructions prior to installation.

Full Cutoff LED Wall Pack

Installation

1. Remove screws and swing front housing down.
2. Drill holes in rear housing for mounting.
Note: For junction box wiring, remove rear pipe plug and for conduit mounting remove one of the side plugs.
3. Measure and create mounting holes on wall as needed.
4. Apply gasket and mount rear housing.
5. Select desired CCT using internal switch.
6. With supply power off, connect wiring.
7. Resecure front housing to rear housing.

Junction Box Installation

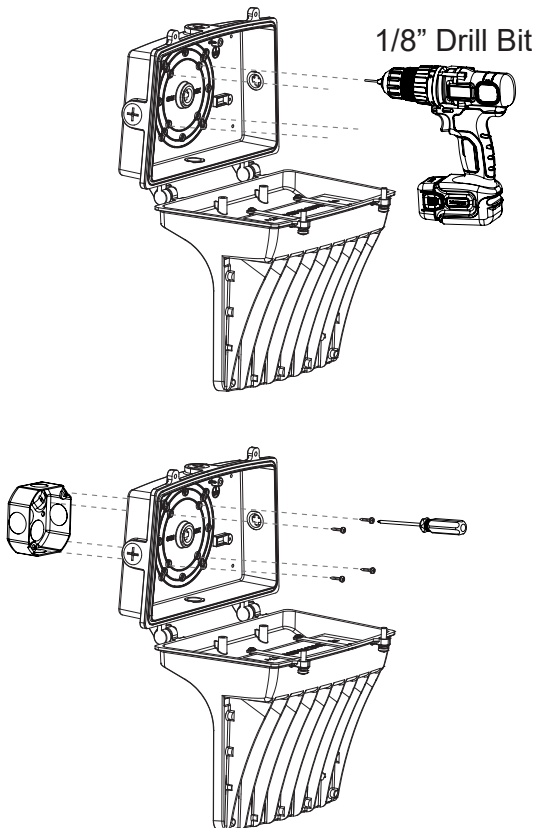

Conduit Installation

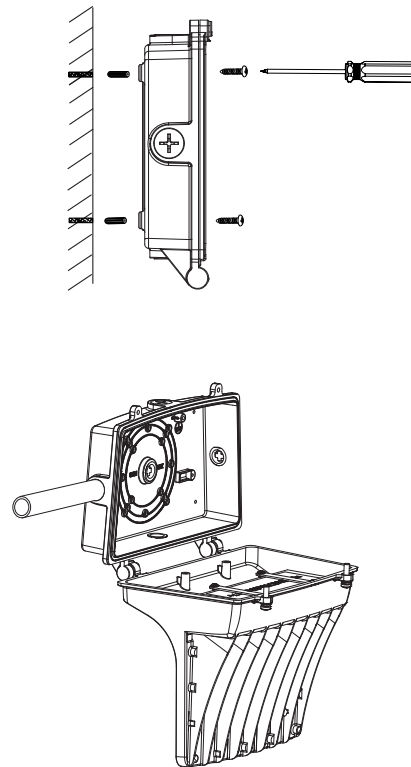

CCT Adjustment

On equipped models, selectable CCT can be set using the internal switch. Make certain supply power is switched off when performing this procedure.

