

Important: Read all instructions prior to installation.

MWPE Series

LED Teardrop Mini Wall Pack with Emergency Backup



Safety and Notes

- Product should be installed and serviced by in accordance with applicable national, state, and local building and electrical codes.
- To reduce the risk of electric shock, ensure that the main power source and circuit breakers are switched off before performing any installation or wiring procedures.
- Avoid looking directly into lamp when illuminated.
- Ensure all mounts are securely attached and will support the weight of the fixture. Failure to properly support fixture may result in damage or injury, for which the manufacturer does not assume responsibility.
- Photocell sensor can be disabled by unplugging it and capping the connector that was attached to the sensor.
- Do not connect emergency battery until all other possible mounting and wiring are complete. Make certain supply power is off when initially connecting the emergency battery.
- Emergency battery requires at least 24 hours of charge time between uses or before initial testing.

Specifications

Model	MWPE-SW15WD-BRP
Ambient Operating Temperature	32°–113° F (0°–45° C)
Environmental Rating	IP65
Dimming	0–10 V
Photocell Operation	Light will turn on when the ambient light level falls below 30 lx and will turn off when the ambient light level exceeds 130 lx.

Check product label for specific electrical specifications related to installation. Improper installation will void warranty.

CCT Selection

To select CCT, open the wall pack and use internal switch to set the desired color temperature. This process should be done prior during installation. If adjustment is needed after installation, make certain to remove supply power before opening the wall pack or making any changes.

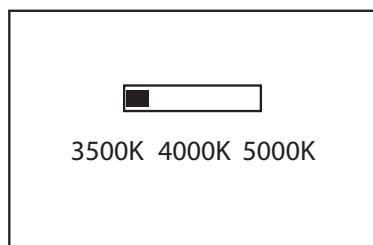

Wiring Diagram

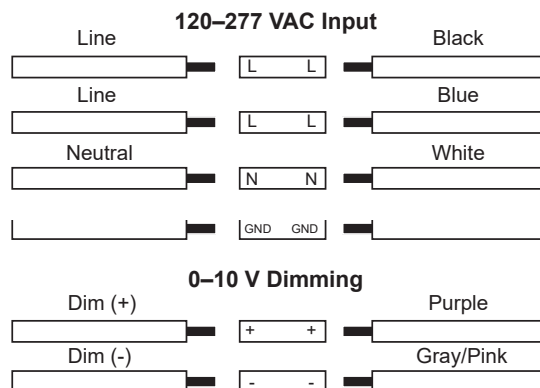

Important: Read all instructions prior to installation.

LED Teardrop Mini Wall Pack with Emergency Backup

Installation

1. Remove screw covers and screws and separate front and rear housings.
Note: There will be two electrical connectors that connect the front and rear, which will need to be disconnected once the fixture is open as well.
2. Select desired CCT value on internal switch.
3. Drill holes in rear housing for mounting, and remove plug for wiring.
4. Mount rear housing to junction box/wall, making certain to use the included gasket.
5. With supply power off, connect supply wiring.
6. Connect the plugs for the emergency battery.

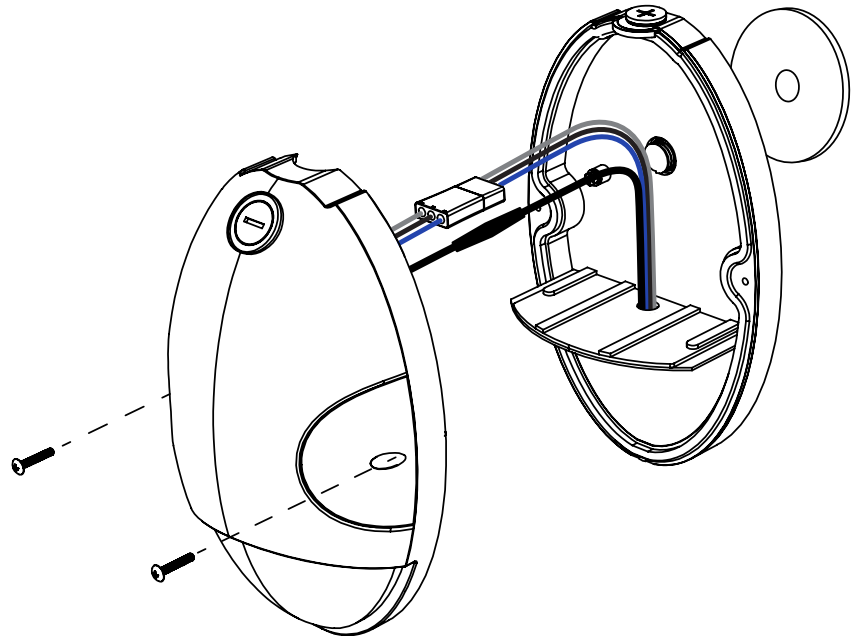
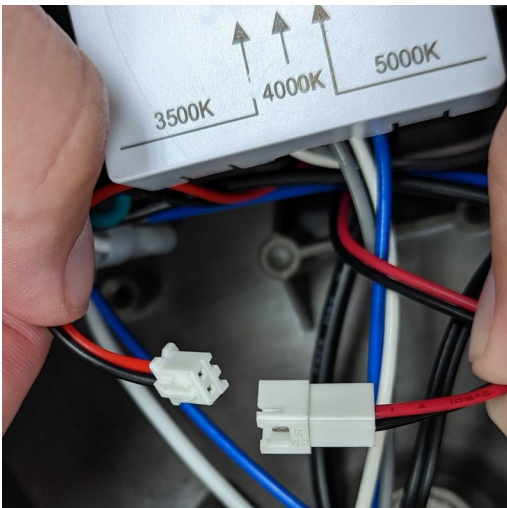

7. Reconnect electrical plug running from front to rear housing and reattach front housing to rear housing.
8. Once secure, apply power and check for proper operation.
Note: Emergency operation test button is at the bottom of the fixture. Fixture will need to charge for 24 hours before initial test.