



CVPSD-60WM-48V



Available Models¹

36 VDC Output

- CVPSD-60WM-36V
- CVPSD-100WM-36V
- CVPSD-150WM-36V

48 VDC Output

- CVPSD-60WM-48V
- CVPSD-100WM-48V
- CVPSD-150WM-48V

Part Number Breakdown

Example: CVPSD-100WM-48V

Series	Output Power	Driver Case	Output Voltage
CVPSD [Constant Voltage Power Supply, Dimmable]	60W [60W]	M [Metal]	36V [36 VDC] or 48V [48 VDC]
	100W [100W]		
	150W [150W]		

Description

The constant voltage power supply powers up to 150W of single-channel strip lights, light bars, and more. This driver is constructed for indoor or outdoor use with an aluminum and/or galvanized steel housing that protects the internal components from moisture and dust. The power supply dimmable and has one output channel. Available in 36 or 48 VDC output options.

Features

- Dimmable: 0-10V, PWM, and Potentiometer (60W, 150W)
- Protected against short circuits, overload, and overvoltage
- 0-10V and Potentiometer (100W)
- Constant voltage PWM output
- IP65 waterproof

Product Details

- Class 2 power supply (60 W and 100 W versions)
- Constant PWM Output: 36 or 48 VDC (as ordered)
- 2kV surge protection
- Universal Input: 120-277 VAC

Certifications and Compliances

- UL Recognized - UL 8750 (FKSZ2)
- Class 2 - UL 1310 (60W and 100W models)
- FCC compliant



Applications

- Downlighting • Offices
- Flood Lights • Retail Shops
- Hospitality • Wall Sconces

Optional Accessories

- 6 ft, 5-15P power cord (POWERCORD)

Warranty

- 5-year warranty

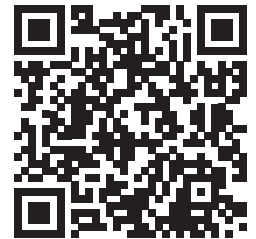



CVPSD Series

Constant Voltage Power Supply Specifications

Specifications

MODELS	CVPSD-60WM-36V	CVPSD-100WM-36V	CVPSD-150WM-36V	
OUTPUT				
Output Power	60W	100W	150W	
Output Voltage	36 VDC			
Output Current	0.16-1.66A	0.27-2.7A	0.416-4.16A	
Output Channels	1			
INPUT				
Input Voltage	120-277 VAC			
Input Frequency	50/60Hz			
Input Current	120 VAC	600mA	980mA	1480mA
	277 VAC	260mA	420mA	620mA
Efficiency (typical)	88%	90%	91%	
Input Power	68W	111W	163W	
Inrush Current (max)	30A	40A	45A	
Power Factor	≥0.9			
Total Harmonic Distortion	THD≤20%			
DIMMING				
Dimming Control	0-10V, PWM, Potentiometer	0-10V, Potentiometer	0-10V, PWM, Potentiometer	
PWM Output Frequency (TYP)	880Hz	440Hz	870Hz	
0-10V Circuit Frequency	480Hz-1kHz			
PROTECTIONS				
Protection Types	Short Circuit, Overload, and Overvoltage			
Surge Rating	2kV			
ENVIRONMENTAL				
IP Rating	IP65			
Environmental Rating	Suitable for Damp Locations, Waterproof			
Ambient Operating Temperature	-40 to 50°C (-40 to 122°F)			
Maximum Tcase Temperature	90°C (194°F)			
MECHANICAL HOUSING				
Wire Gauge	18AWG			
Housing Color	Silver	Black	Silver	
Case Material	Aluminum, Galvanized Steel Top	Galvanized Steel	Aluminum Housing	





CVPSD Series

Constant Voltage Power Supply Specifications

Specifications

MODELS		CVPSD-60WM-48V	CVPSD-100WM-48V	CVPSD-150WM-48V
OUTPUT				
Output Power		60W	100W	150W
Output Voltage		48 VDC		
Output Current		0.125-1.25A	0.208-2.08A	0.312-3.12A
Output Channels		1		
INPUT				
Input Voltage		120-277 VAC		
Input Frequency		50/60Hz		
Input Current	120 VAC	600mA	980mA	1480mA
	277 VAC	260mA	420mA	620mA
Efficiency (typical)		88%	90%	91%
Input Power		68W	110W	163W
Inrush Current (max)		30A	40A	45A
Power Factor		≥0.9		
Total Harmonic Distortion		THD≤20%		
DIMMING				
Dimming Control		0-10V, PWM, Potentiometer	0-10V, Potentiometer	0-10V, PWM, Potentiometer
PWM Output Frequency (TYP)		860Hz	450Hz	950Hz
0-10V Circuit Frequency		480Hz-1kHz		
PROTECTIONS				
Protection Types		Short Circuit, Overload, and Overvoltage		
Surge Rating		2kV		
ENVIRONMENTAL				
IP Rating		IP65		
Environmental Rating		Suitable for Damp Locations, Waterproof		
Ambient Operating Temperature		-40 to 50°C (-40 to 122°F)		
Maximum Tcase Temperature		90°C (194°F)		
MECHANICAL HOUSING				
Wire Gauge		18AWG		
Housing Color		Silver	Black	Silver
Case Material		Aluminum, Galvanized Steel Top	Galvanized Steel	Aluminum Housing



CVPSD Series

Constant Voltage Power Supply Specifications

Dimensional Drawings

CVPSD-60WM-x

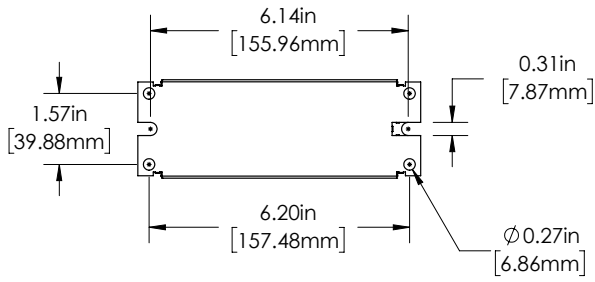
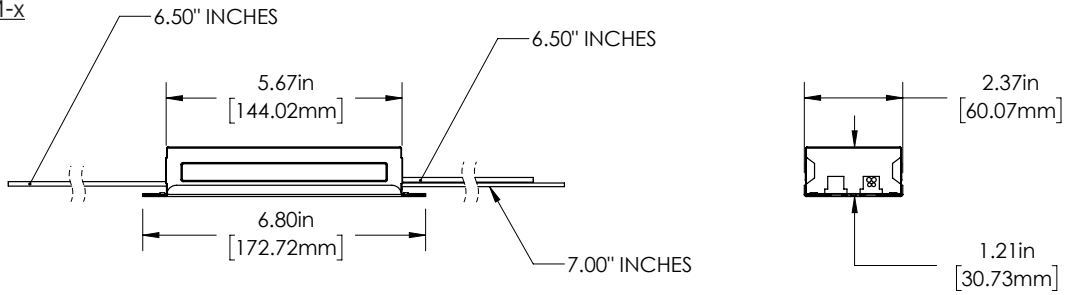

CVPSD-100WM-x

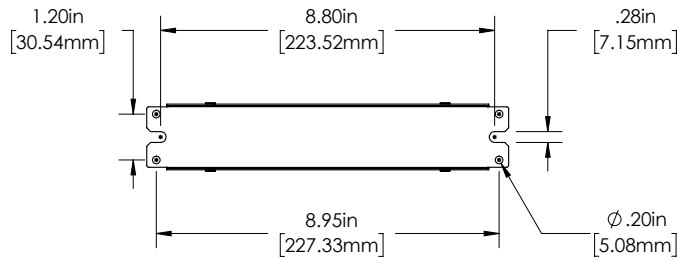
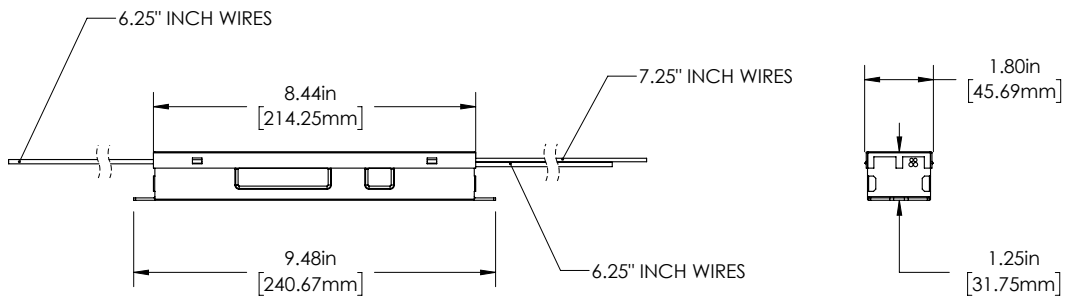

CVPSD Series

Constant Voltage Power Supply Specifications

Dimensional Drawings

CVPSD-150WM-x

