

Important: Read all instructions prior to installation. SAVE THESE INSTRUCTIONS.

LED Exit and Emergency Light

Specifications

XSCS2-RW	
Total Power Consumption	3 W
Operating Voltage Range	120–277 VAC
Operating Temperature	50°–104° F (10°–40° C)
Environmental Rating	Suitable for Damp Locations
Recommended Mounting	7.5 ft (2.3 m) height, 30–35 ft (9.1–10.7 m) center-to-center spacing between lights 10 ft (3 m) height, 28–30 ft (8.5–9.1 m) center-to-center spacing between lights

Important Safeguards

Read and follow all safety instructions. When using electrical equipment, basic safety precautions should always be followed including the following:

- This product should be installed and serviced by a certified electrician in accordance with applicable national, state, and local building and electrical codes.
- Light must be maintained, tested, and serviced in accordance with all applicable National Fire Protection Association (NFPA) and local codes.
- To reduce the risk of electric shock, ensure that the main power source and circuit breakers are switched off before performing any installation or wiring procedures.
- Ensure fixture is securely mounted and mount will support weight of the fixture. Failure to properly support fixture may result in damage or injury, for which the manufacturer does not assume responsibility.
- Equipment should be mounted in locations and at heights where it will not be subjected to tampering by unauthorized personnel.
- Indoor use only—do not use outdoors.
- Do not mount near gas or electric heaters or any other radiant heat sources.
- Use caution when handling or servicing the battery pack.
- For conduit wiring installation, use flexible conduit only
- The use of accessory equipment not recommended by the manufacturer may cause an unsafe condition.
- Do not use this equipment for anything other than its intended use.

Testing

Manual Test button can be held to illuminate lights for manual testing purposes.

¹Limited 2-year warranty on battery.



Converting for Dual-Sided Operation

Converting for Dual-Sided Operation

1. Remove screw from side panel.
2. Slide to remove the blank rear panel.
3. Install additional "EXIT" panel.
4. Reinstall side panel.

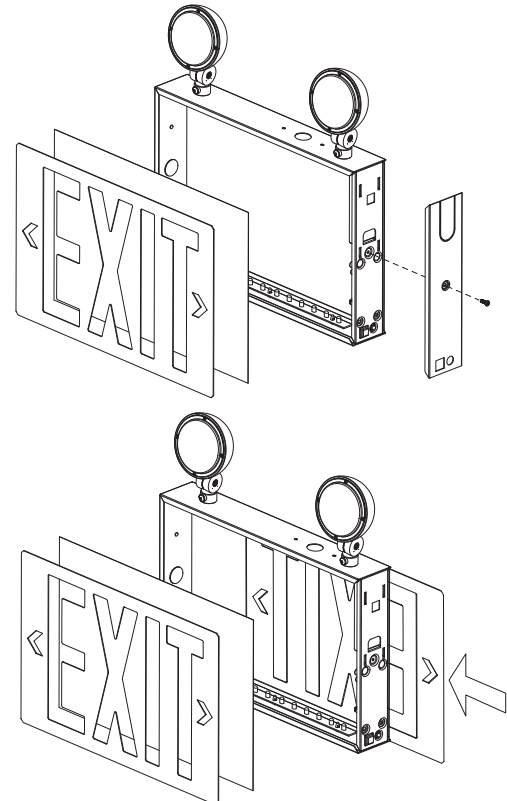

Wiring Diagram

120–277 VAC	BLACK
NEUTRAL	WHITE
GROUND	GREEN



Important: Read all instructions prior to installation. SAVE THESE INSTRUCTIONS.

LED Exit and Emergency Light

Installation Instructions (Rear Mount)

1. Turn off supply power at breaker box.
2. Remove screw that holds side panel in place and remove side and front panels.
3. Remove appropriate knockouts for wiring and mounting from rear and/or side panel.
4. Using an appropriate strain relief (not included) run wiring through case and connect wiring.
5. Securely mount fixture to wall/junction box.
6. Connect battery.
7. Remove arrow knockouts from front cover as needed, then slide front cover into place.
8. Reinstall side cover.
9. Apply power and allow battery pack to charge for at least 24 hours before initial test.
10. After 24-hour period, press test button to make certain emergency lights are functioning as intended and are aimed correctly.

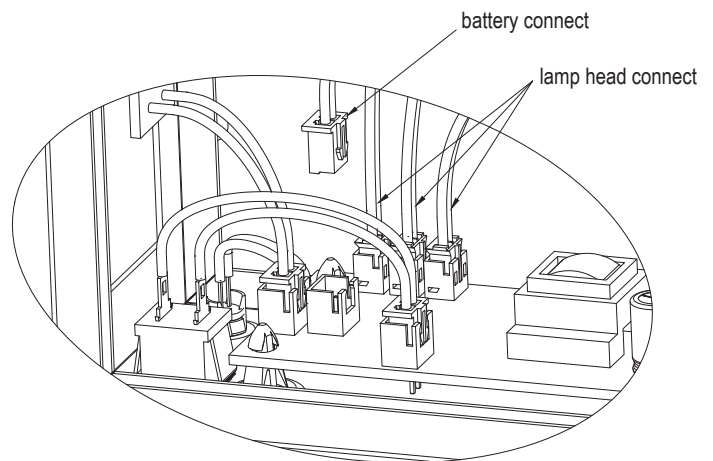
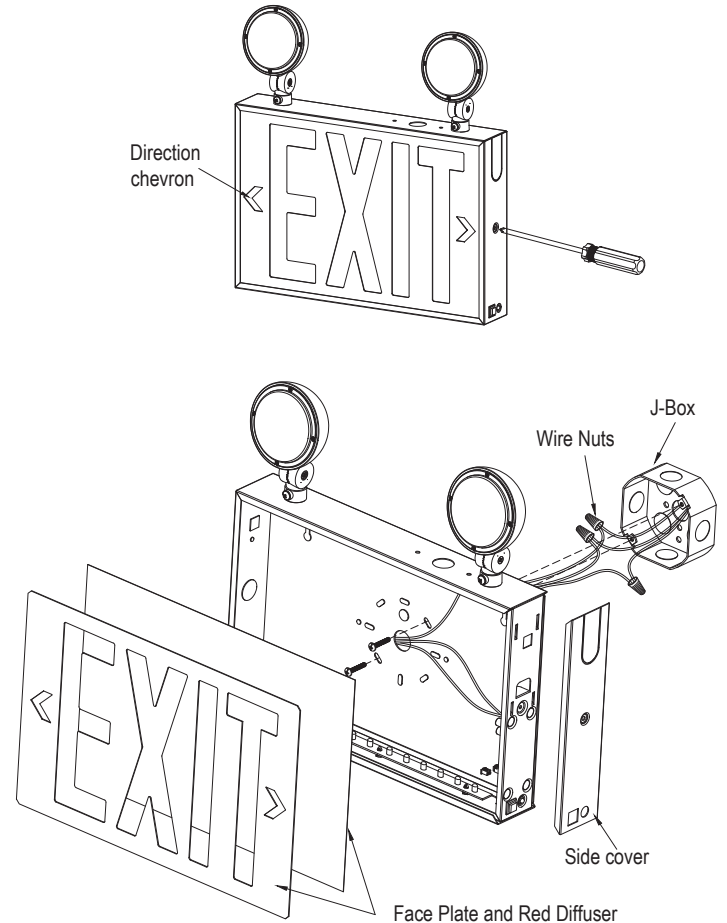

¹Limited 2-year warranty on battery.



Important: Read all instructions prior to installation. SAVE THESE INSTRUCTIONS.

LED Exit and Emergency Light

Installation Instructions (Side Mount)

1. Turn off supply power at breaker box.
2. Remove screw to release side cover.
3. Slide face plate "EXIT" panel to remove.
4. Run wiring through canopy and adapter plate, then attach canopy to light.
5. Make all wiring connections.
6. Install adapter plate bracket on junction box.
7. Securely attach to junction box.
8. Connect wiring for battery.
9. Reinstall "EXIT" panel(s). Knock-out directional arrow covers as needed.
10. Reinstall side cover.
11. Turn on supply power and allow battery pack to charge for at least 24 hours before initial test.
12. After 24-hour period, press test button to make certain light is functioning as intended.

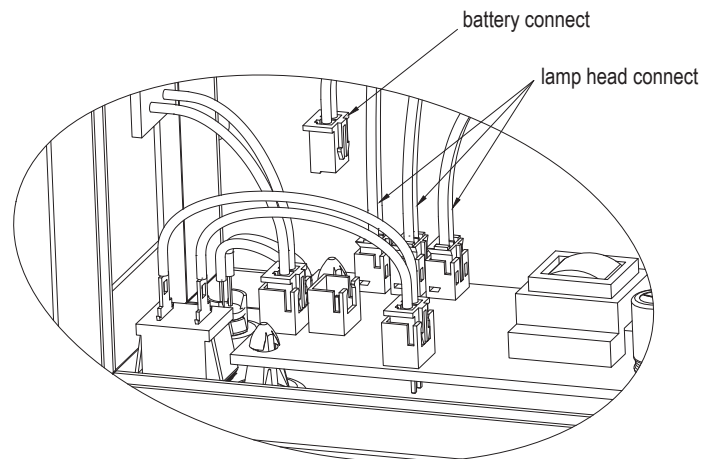
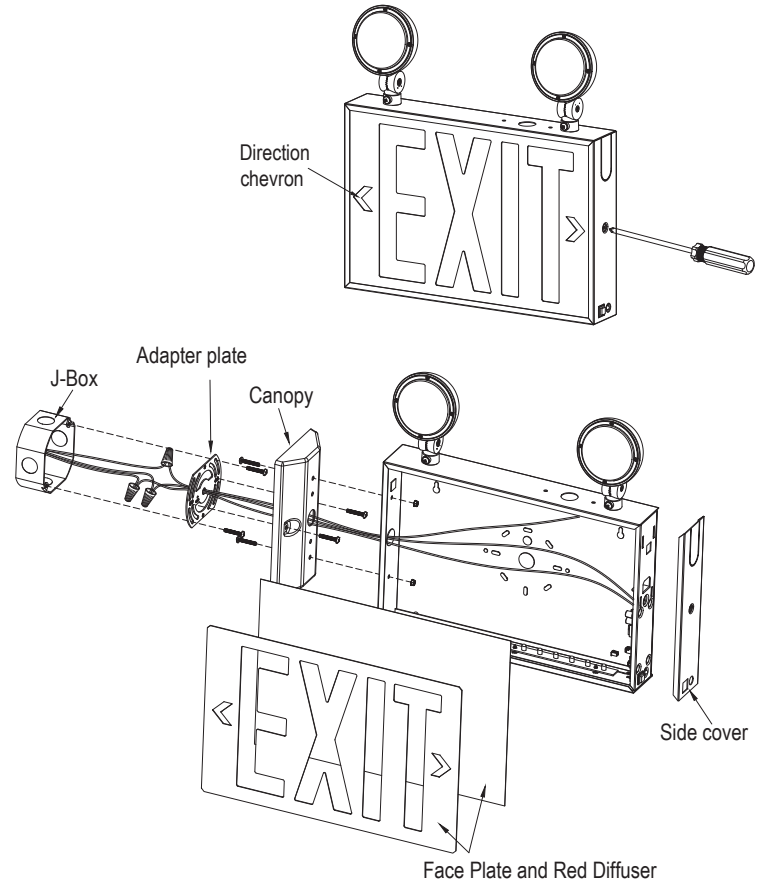

¹Limited 2-year warranty on battery.

