



SWL-x20-SFA



Available Models¹

- ☐ SWL-B20-SFA
- ☐ SWL-R20-SFA

Part Number Breakdown

Example: SWL-R20-SFA

| Series | Color | Wattage | Beam |
|--------|----------|-----------|-----------------------------------|
| SWL | B [blue] | 20 [20 W] | SFA [sequentially flashing arrow] |
| | R [red] | | |

Description

These LED forklift safety lights feature a sequentially flashing arrow beam to alert pedestrians or other machinery of an approaching warehouse vehicle. The flashing arrow is visible from up to 20 ft and improves safety in areas with limited visibility, such as blind corners. The 20W warning light has a durable, die-cast aluminum housing and shatter-resistant polycarbonate lens. The projection distance can be adjusted by angling the light on the stainless steel bracket. Available with a blue or red beam.

Construction

- Die-cast aluminum housing
- Adjustable stainless steel bracket
- Shatter-resistant polycarbonate lens
- IP67 rated, waterproof
- -40–176 °F (-40–80 °C)

Electrical

- 12-60 VDC input
- 50,000 hour LED lifetime

Photometrics

- Red or Blue LEDs
- Sequentially flashing arrow beam

Application

These LED forklift lights are ideal for workplace safety lighting in material handling applications on automated guided vehicles, forklifts, and other industrial vehicles.

Warranty

Lifetime Warranty

Product Page QR Code



T 866.811.5550

F 314.972.6202

email: commercial-sales@superbrightleds.com

www.superbrightleds.com/cat/industrial-led-lighting/

¹Contact customer service if interested in options other than those listed.

SWL Series

Sequentially Flashing Arrow LED Forklift Light

Dimensional Drawings

SWL-x20-SFA

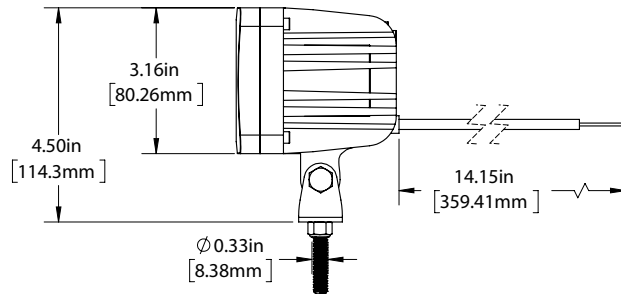
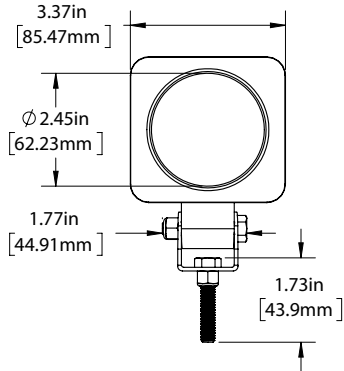

HOLE NEEDED FOR THE SCREW

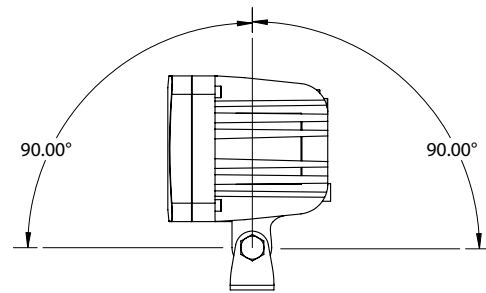
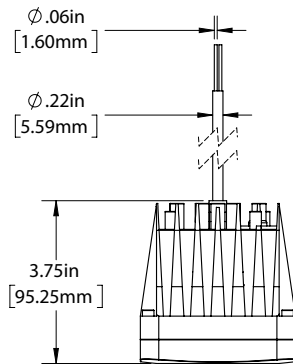

Specifications

| Model | | SWL-B20-SFA | SWL-R20-SFA |
|-------------------------------|--------|------------------------|-------------|
| Color | | Blue | Red |
| Operating Voltage | | 12-60 VDC | |
| Power Consumption | | 20 W | |
| Current Draw | 12 VDC | 1.7 A | |
| | 24 VDC | 830 mA | |
| | 36 VDC | 555 mA | |
| | 48 VDC | 415 mA | |
| Beam Pattern | | Sequential Arrow | |
| IP Rating | | IP67, waterproof | |
| Rated Life (L70) | | 50,000 hours | |
| Ambient Operating Temperature | | -40—176 °F (-40—80 °C) | |

