

User Manual

Solar-Powered LED  
Bollard Lights



LFSMB-xWBK-2PK

Important: Read all instructions prior to installation.

Parts Diagram

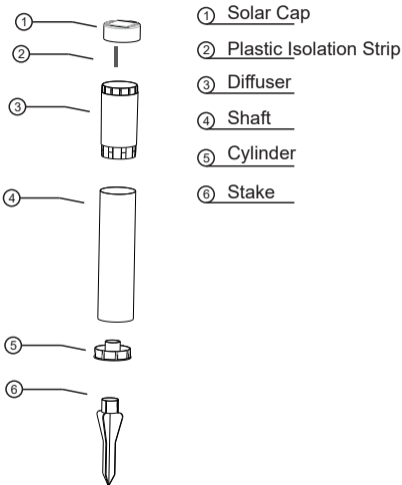

Installation

- 1.Remove cover and plastic isolation strip. Internal battery will now be connected and LED will have power.
- 2.Connect the product together as shown in the diagram.
- 2.Test solar head switch by covering it to block the light. LED should turn on automatically.
- 3.Insert ground stake and push into the ground.

Note: Ensure installation location has suitable sunlight for proper charging.

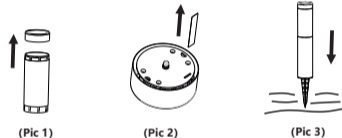

Safety and Notes

- Not for underwater use or use with submersible or pool/spa equipment.
- Light will shut off automatically in excessively cold temperatures (below minimum operating temp.) to protect the light.
- Solar panel must be cleaned at least every three months for best operation.
- Weather and physical obstructions that block sunlight will negatively affect the ability of the light to charge.
- Ensure light is installed in a location that receives direct sunlight.

Troubleshooting

Problems	Reasons	Solutions
Not working	power off	Charge under the sun
	Do not cover the solar panel	Cover with the cloth
Short work time	The battery is damaged due to its service life	Change the new battery
	Place the product without sunshine	Place the product under the sun
	Winter and the rainy days	Check after the fully charge

Warranty Info

Warranty The product can be used for one year in the normal use and preservation process.  
with this card, one year's free warranty is provided from the date of purchase  
The following conditions shall not enjoy the warranty  
1 can't produce the warranty invoices without authorization or purchase vouchers  
2 dismantling converted the damage is the product) in the process of using handling inadvertently dropped to cause damage or malfunction,  
Do not according to the instruction to use the maintenance and cause damage because of the company authorized the repair damaged due to improper maintenance organizations,  
Damage is caused due to unforeseen natural disasters beyond warranty period