

**Important: Read all instructions prior to installation.**

**LRK Series**

### LED Retrofit Kit



LRK-50K100T

#### Safety and Notes

- Risk of fire or electric shock. LED Retrofit Kit installation requires knowledge of fixture's electrical system. If not qualified, do not attempt installation and contact a qualified electrician.
- Only install this kit in fixtures that have construction features and dimensions that will allow proper installation. Ensure the power consumption of retrofit kit does not exceed the rating of the fixture.
- If drilling is required during installation of kit use caution not to damage wiring or other components.
- To prevent damage to kit, ballast must be bypassed.
- LED chips should not be touched by hands or any other installation tools. Use included protective cover while installing retrofit.
- Ensure all parts are present and power is off prior to installation.

#### Safety and Notes

Environmental Specifications	
Operating Temperature	-4°–113° F (-20°–45° C)
Environmental Rating	non-weatherproof

#### Parts Included

Name	Qty	
Lamp	1 pc	
Driver	1 pc	
Mounting Bracket	1 pc	
U-Bracket	1 pc	
M6 Hexagonal Head Bolt	1 pc	
Lock Washer	1 pc	
M4 Screw	45 W, 100 W, 120 W - 2pcs	150W - 4pcs
Crimp-on Wire Nut	5 pcs	
2 Pin Terminal Blocks	1 pc	
3 Pin Terminal Blocks	1 pc	

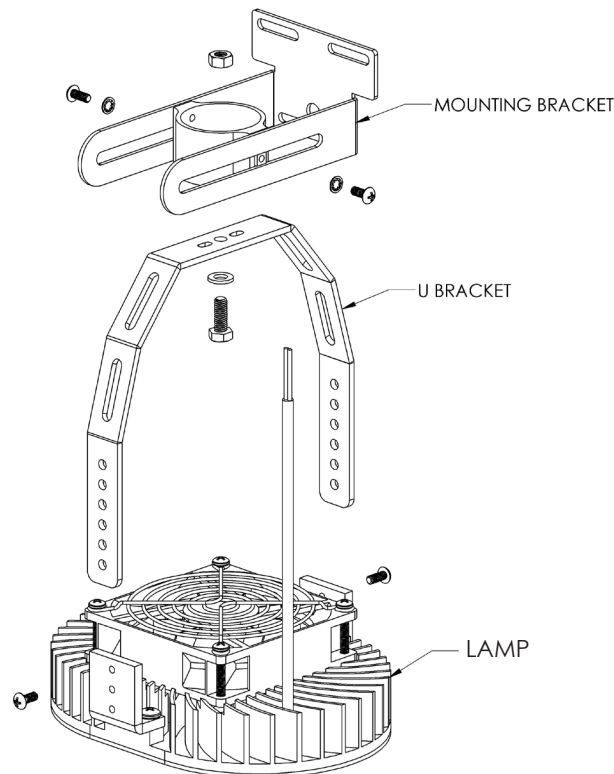

**Important: Read all instructions prior to installation.**

## LED Retrofit Kit

### Installation

1. Attach U-Bracket to lamp using Phillips Head M4 screws. Do not tighten (Fig. 1).

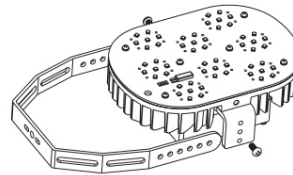

**FIG 1**

2. Attach Mounting Bracket to U-Bracket using M6 Bolt, Nut, and Locking Washer. Method of mounting will depend on fixture being retrofitted. Do not tighten bolt (Fig. 2).

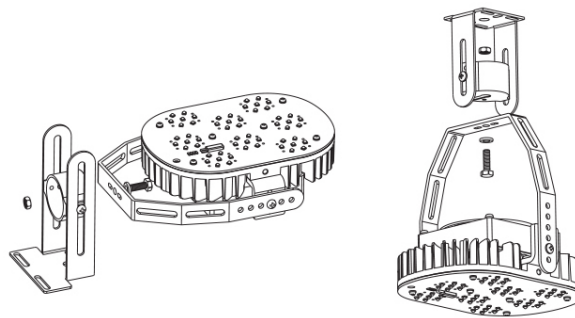

**FIG 2**

3. Attach Mounting bracket to fixture. Hardware for mounting kit to fixture is not included. Adjust lamp angle, Mounting Bracket height and U-Bracket position until lamp is in desired position. Tighten screws (Fig. 3).

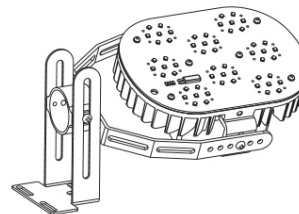

**FIG 3**

*Note: Ensure ballast has been bypassed prior to step 4.*

4. Mount driver into fixture and make connections as shown in Fig. 4. Hardware for mounting is not included. Remove protective cover on lamp prior to restoring power.

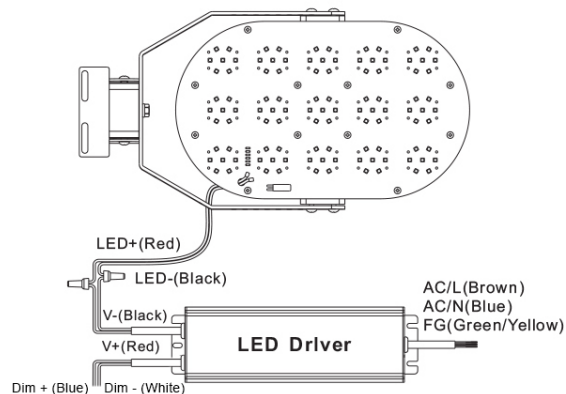

**FIG 4**

*Note: 45 W model is not dimmable.*