

**Important: Read all instructions prior to installation.**

## Gooseneck Barn Light



GBL-SW3B8-11BK

### Safety and Notes

- Product should be installed and serviced in accordance with applicable national, state, and local building and electrical codes.
- To reduce the risk of electric shock, ensure that the main power source and circuit breakers are switched off before performing any installation or wiring procedures.
- Avoid looking directly into lamp when illuminated.
- Ensure all mounts are securely attached and will support the weight of the fixture. Failure to properly support fixture may result in damage or injury, for which the manufacturer does not assume responsibility.

### Specifications

#### Environmental Specifications

Operating Temperature	-40°–104° F (-40°–40° C)
IP Rating	IP65

Check product label for specific electrical specifications related to installation.  
Improper installation will void warranty.

### Wiring Diagram

#### 120–277 VAC Input

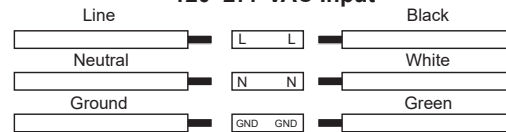

### Installation

1. Select desired CCT on mount side of light.
2. Assemble shade reflector onto lamp body. Use the keyhole slots and secure with screws.
3. Remove supply power, and feed wiring through silicone gasket and mounting bracket.
4. Make all wiring connections and secure with twist on wire connectors.
5. Connecting mounting bracket to light with provided hardware. Secure fixture and bracket to junction box. Screw on caps, and tighten evenly.  
Note: It is recommended that silicone caulk be applied around the edge of wall canopy to weatherproof.
6. Apply supply power.

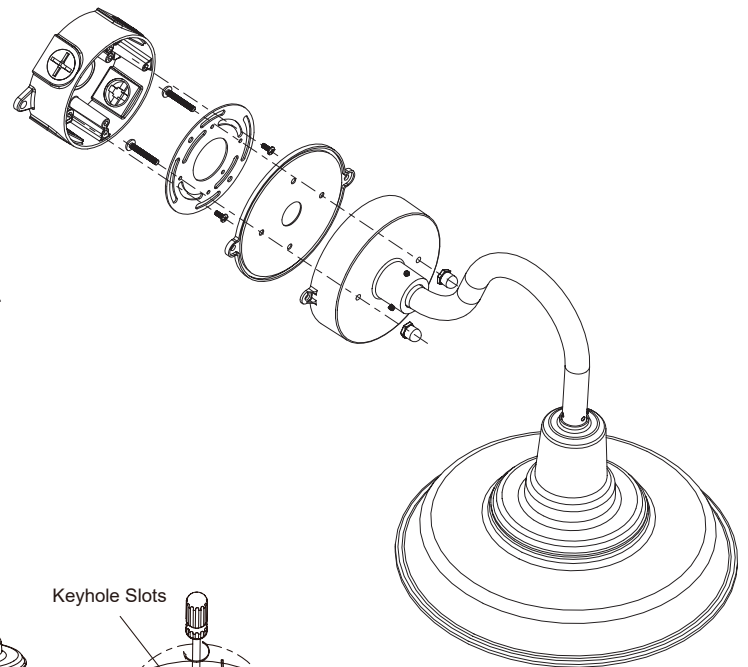

Color Temperature

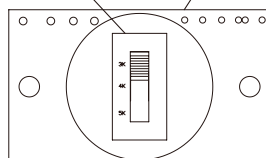

Keyhole Slots

