

Important: Read all instructions prior to installation. SAVE THESE INSTRUCTIONS.

LED Exit Signs

Specifications

Model	XS-RG	XSC-RG
Power Consumption	1 W	2 W
Input Voltage	120/277 VAC	120–277 VAC
Operating Temperature	32°–104° F (0°–40° C)	

Important Safeguards

Read and follow all safety instructions. When using electrical equipment, basic safety precautions should always be followed including the following:

- This product should be installed and serviced by a certified electrician in accordance with applicable national, state, and local building and electrical codes.
- Light must be maintained, tested, and serviced in accordance with all applicable National Fire Protection Association (NFPA) and local codes.
- To reduce the risk of electric shock, ensure that the main power source and circuit breakers are switched off before performing any installation or wiring procedures.
- Ensure fixture is securely mounted and mount will support weight of the fixture. Failure to properly support fixture may result in damage or injury, for which the manufacturer does not assume responsibility.
- Equipment should be mounted in locations and at heights where it will not be subjected to tampering by unauthorized personnel.
- Indoor use only—do not use outdoors.
- Do not mount near gas or electric heaters or any other radiant heat sources.
- Use caution when handling or servicing the battery pack.
- For conduit wiring installation, use flexible conduit only.
- The use of accessory equipment not recommended by the manufacturer may cause an unsafe condition.
- Do not use this equipment for anything other than its intended use and do not use with accessories not included with this equipment.
- Do not repair or modify arbitrarily. Do not replace any part of the light including LED board and transformer/driver without consulting the manufacturer or authorized distributors.
- Battery in this unit may not be fully charged when purchased. After electricity is connected to the unit, let the battery charge for at least 24 hours before testing.
- On XS-RG model, never connect red and black wires at the same time. Only one should be connected to the appropriate voltage at any time.



XS-RG (in green configuration)

Dual-Sided Operation / Changing Lettering Color

1. Carefully remove the “EXIT” panel using a flat-head screwdriver to release tabs.
2. To swap color, remove the diffuser and swap with the other included one, then switch the LED color using the internal selection switch.
3. For dual-sided use, remove the blank rear panel using a flat-head screwdriver to release tabs and replace with additional exit panel.

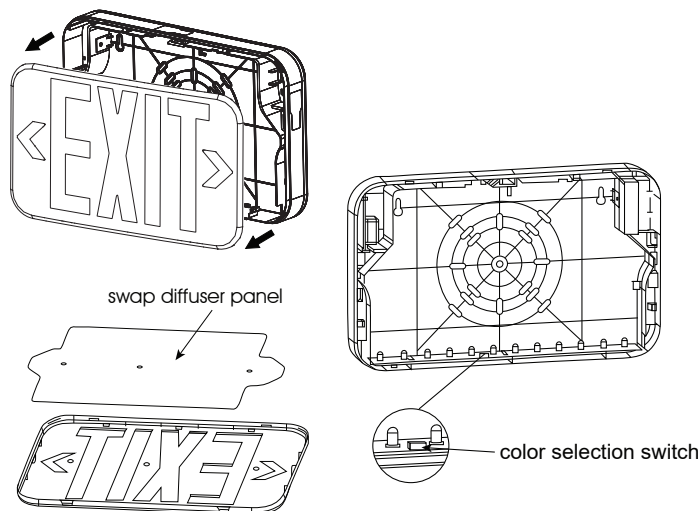

Wiring Diagram

XSC-RG		
White	—	Neutral
Red	—	Line (120–277 VAC)
XS-RG		
White	—	Neutral
Red	—	Line (277 VAC)
Black	—	Line (120 VAC)

¹Limited 2-year warranty on battery.

Important: Read all instructions prior to installation. SAVE THESE INSTRUCTIONS.

LED Exit Sign

Ceiling or Side Mount Installation

1. Disconnect supply power.
2. Carefully remove the "EXIT" panel using a flat-head screwdriver to release tabs.
3. Swap color and install additional exit panel for dual sided use if desired.
4. Run wiring through mounting bracket, then attach mounting bracket to light.
5. Install mounting bracket on junction box and connect supply wiring. On XS-RG model, cap unused wire.
6. Mount light to mounting bracket.
7. Connect battery.
8. Reinstall "EXIT" panel. Install/remove directional arrow covers as needed.
9. On XSC-RG, aim emergency light heads as needed.
10. Restore supply power and allow battery pack to charge for at least 24 hours before initial test.
11. After 24-hour period, press test button to make certain light is functioning as intended.

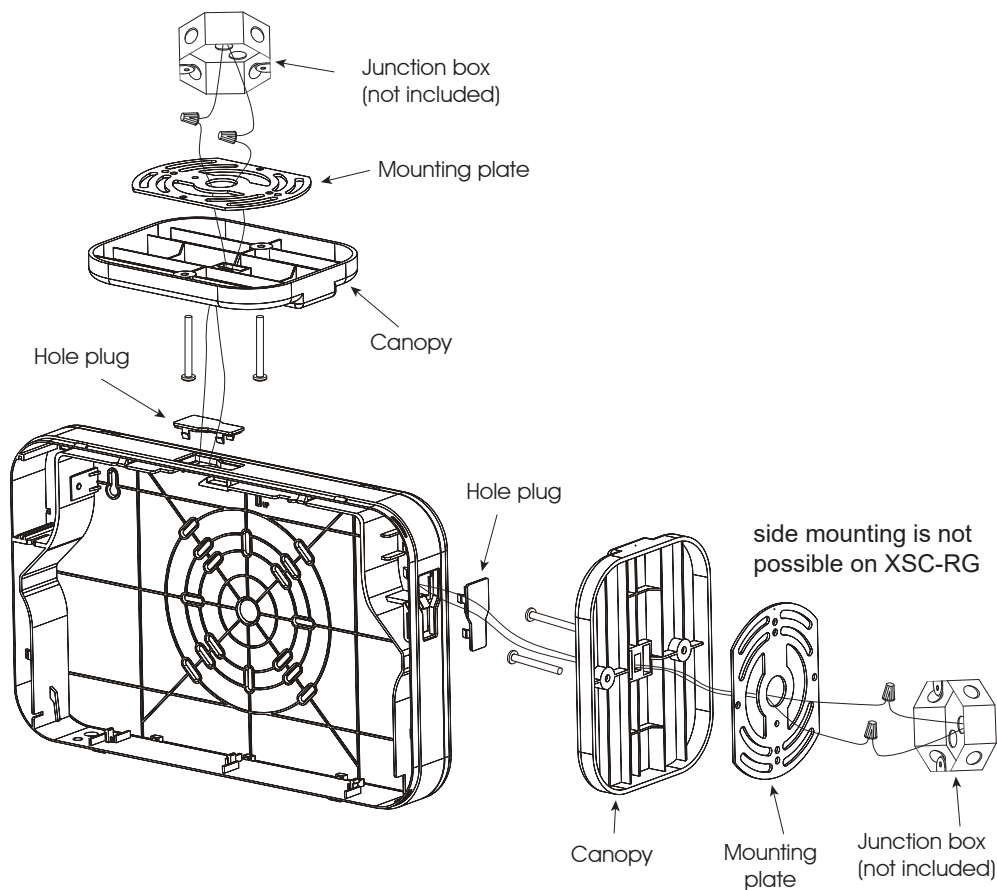

¹Limited 2-year warranty on battery.



Important: Read all instructions prior to installation. SAVE THESE INSTRUCTIONS.

LED Exit Sign

Rear Wall Installation

1. Disconnect supply power.
2. Carefully remove the "EXIT" panel using a flat-head screwdriver to release tabs.
3. Swap color and install additional exit panel for dual sided use if desired.
4. Make holes in rear panel for wiring and mounting.
5. Connect supply wiring. On XS-RG model, cap unused wire.
6. Attach light to wall.
7. Connect battery.
8. Reinstall "EXIT" panel. Install/remove directional arrow covers as needed.
9. On XSC-RG, aim emergency light heads as needed.
10. Restore supply power and allow battery pack to charge for at least 24 hours before initial test.
11. After 24-hour period, press test button to make certain light is functioning as intended.

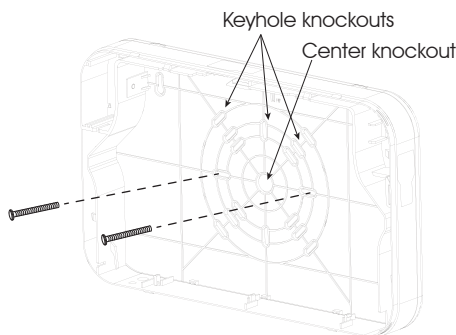
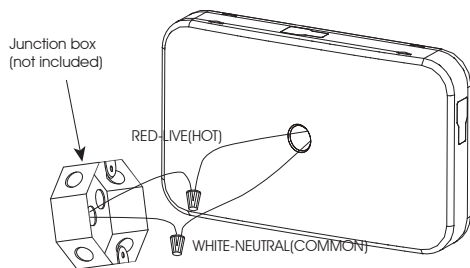
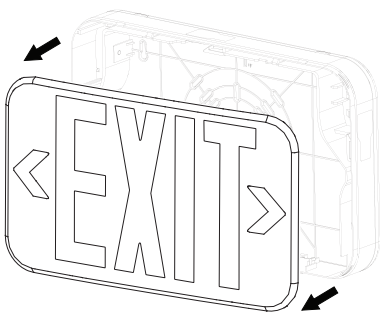

¹Limited 2-year warranty on battery.

